

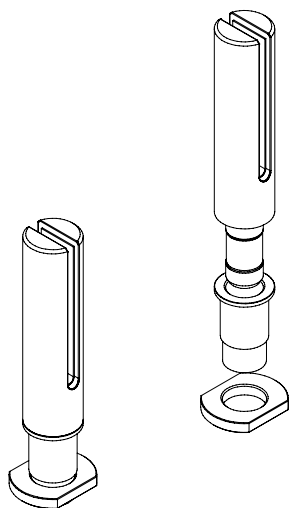

## Model Specifications

---

<b>Design Features</b>	<p>The Twin Feet Fixing system was created to improve safety around open fireplaces. Designed to lock a glass fire screen into position these stainless steel feet provide permanent stability, and at the same time allow for easy removal for refueling and maintenance.</p> <p>This unique Twin Feet Fixing system ensures that the screen cannot be knocked down by children or pets as well as enhancing safety in public places such as bars and restaurants.</p>
<b>Construction Detail</b>	<p>There are 3 main elements to the design:</p> <p>Main Stainless Steel Body – includes two (2) nylon grab screws at the back and a spigot that locks into the receiver when inserted vertically.</p> <p>PVC Sleeve – designed to protect the glass panel from the stainless steel and to lock the panel into position without the need for holes in the glass.</p> <p>Stainless Steel Receiver – a vertical cylinder that can be screwed or glued into position, anchors into the ground ready to accept the main stainless steel body. If being screwed into position (e/g for floating benches or cabinetry installations) a nut is included.</p> <p>The main body can be removed from the receiver at any time in order to allow access to the fire for cleaning and refueling.</p>
<b>Glass Panel NOT INCLUDED</b>	<p>The panel of glass is not included – this will have to be organized separately and specified according to the design of the fireplace. The glass should be 6mm [.023in] toughened glass ONLY. No holes are required.</p> <p>The glass panel should cover a maximum of two thirds (<math>\frac{2}{3}</math>) the opening of the fireplace – in the case of public spaces where a greater proportion of the opening must be covered, the glass must sit a minimum of 175mm [6.89in] away from the front of the fireplace.</p>
<b>Installation</b>	<p>The Twin Feet Fixings are delivered in one package.</p> <p>Installation is via a vertical seamless receiver inserted into the floor, which anchors a pane of glass held by the Twin Feet Fixing system into position.</p> <p>The pane of glass is locked into position using nylon grab screws (no holes are required) and an Allen Key.</p> <p>The fixing should sit a minimum of 120mm [4.72in] from the front of the mantel. Depending on the environment, it might be best to install a second set of receivers in another position to ensure that when the panel of glass is removed from the fireplace guard position, it does not get damaged.</p> <p>The floor must be level and the Twin Feet Fixings positioned on a flat surface.</p> <p>The floor may be made of any material. If installing on carpet, cut a diameter equivalent to the receiver to provide solid bonding to a hard surface, to ensure the stability of the screen.</p>



ISOMETRIC VIEW

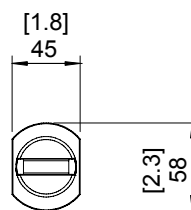

TOP VIEW

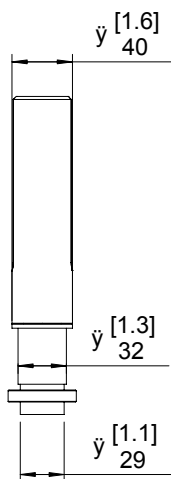

FRONT VIEW

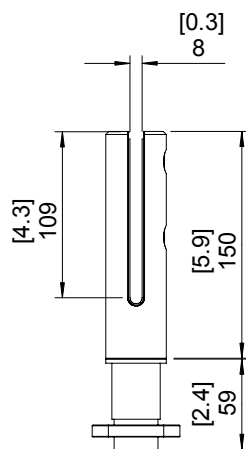

SIDE VIEW



REAR VIEW

**Measurements**

[inches] = imperial  
mm = metric

**Weight**

1.5kg, 3.5lbs

**Materials**

Machined Stainless Steel

Scale 1:5

